

# Lab-Putty

## Instructions for use

EN

### Definition

COLTENE Lab-Putty is an elastomeric putty for use in the dental laboratory.

### Material type

Polysiloxane, condensation-type elastomer.

### Indications

COLTENE Lab-Putty is exclusively designed for extraoral application.

It has been conceived for the manufacture of:

- Matrix
  - Repro, general occlusion and functional pattern (gfp), matrix as positioner for clasps, denture teeth (i.e. partial dentures, temporary partials, orthodontic retainers etc.), matrix for making gingival masks COLTENE Gi-Mask.
- Repairmodels
  - (lower dentures with deep undercuts)
- Block-outs
  - Hard palate relief stamp (mould)
- Labial/buccal positioner matrix

### Contra-indications

Provided that the product is used as directed, there are no known contra-indications.

### Side effects / Interactions

Polysiloxanes have a very good biological compatibility.

Up to now no harmful reactions or secondary effects on laboratory staff are known.

### Dosage

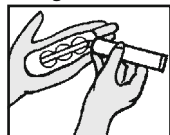

Measure out COLTENE Lab-Putty Base with the measuring scoop (take off excess). Spread measured out quantity on the palm of the hand. For each scoop Base press the scoop-rim once into the mass. Dose one strand-length of COLTENE Lab-Putty Activator per circle diameter.

**Close tube immediately after use.**

### Mixing

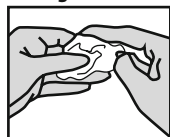

Fold material and knead with fingertips for 30-45 s until a homogeneous, pink-colored mixture is produced.

### Setting time

Min. 5-7 min at room temperature.

Intensive mixing, high temperatures or over-dosage of the activator speed up the setting.

Low temperatures and under-dosage of the activator slow down the setting.

Max. over-dosage/under-dosage: 20%

### Shelf life and storage

COLTENE Lab-Putty fulfills the intended purpose at least until the expiry date, which is displayed on the containers, when stored at 15-23°C/59-73°F and 50% relative air humidity.

### Marking

The expiry date and **LOT** number are shown on the package and cartridge.

### Technical data

Mixing time:	30-45 s
Total working time:	ca. 90 s
Setting time:	5-7 min
Shore A hardness:	63-70
Mixing ration Putty : Activator	11.0 g : 0.3 g

### Mixing conditions

The stated working time is based on measurements at 23°C/73°F room temperature and 50% relative humidity.

### Lab Putty Activator

#### NOTICE

Contains Alkyl silicates, Dioctyltin oxide, Dioctyltin dineodecanote



GHS02



GHS08



GHS07

#### WARNING

H226 Flammable liquid and vapour.

H315 Causes skin irritation.

H319 Causes serious eye irritation.

H332 Harmful if inhaled.

H335 May cause respiratory irritation.

H371 May cause damage to organs.

H373 May cause damage to organs through prolonged or repeated exposure.

H413 May cause long lasting harmful effects to aquatic life.

P260 Do not breathe mist/vapours/spray.

P280 Wear protective gloves/protective clothing/eye protection and face protection.

P302+P352 IF ON SKIN: Wash with plenty of water.

P304+P340 IF INHALED: Remove person to fresh air and keep comfortable for breathing.

P305+P351+P338 IF IN EYES: Rinse cautiously with water for several minutes. Remove contact lenses, if present and easy to do. Continue rinsing.

P332+P313 If skin irritation occurs: Get medical advice/attention.

P337+P313 If eye irritation persists: Get medical advice/attention.

P405 Store locked up.

P501 Dispose of contents/container to authorised hazardous or special waste collection point in accordance with any local regulation.

Only supplied to dentists and dental laboratories or upon their instructions.

### Caution:

Federal law restricts this device to sale by or on the order of a dentist.

## SAFETY DATA SHEET

[www.coltene.com](http://www.coltene.com)

## Glossary



Consult instructions for use



Keep away from sun light



Temperature limitation



Expiry date

## Coltène/Whaledent AG

Feldwiesenstrasse 20  
9450 Altstätten/Switzerland  
T +41 71 757 5300  
F +41 71 757 5301  
[info.ch@coltene.com](mailto:info.ch@coltene.com)